

# CONTI®

POST TOILETING

## Instructions For Use Cleansing Wet Wipes



The Conti® Post Toileting range provides a fully dispersible cleansing solution suitable for safe and hygienic disposal in a toilet or macerator. The plastic free cellulose-based wipe also provides a more environmentally friendly, sustainable alternative.

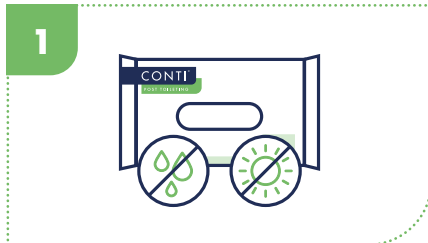

**Keep product dry and out of direct sunlight.**

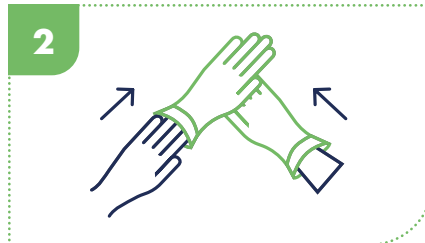

**Wash/dry hands and apply clean protective apron and gloves.**

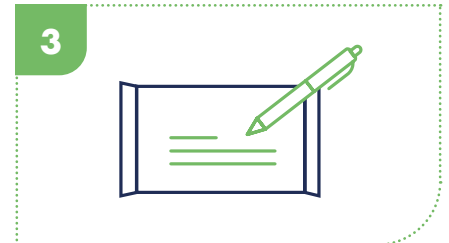

**Assign individual's details to wipe pack.**

Ensure individual's privacy and reassure them.

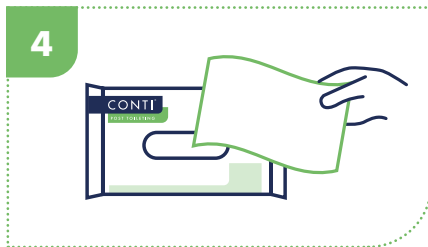

**Remove only one wipe from the pack at a time.**

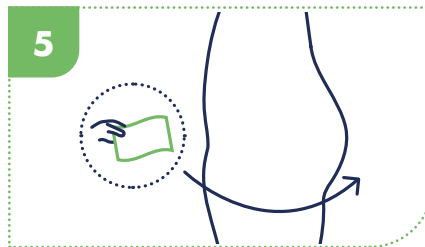

**Remove and dispose of any continence aids or follow procedures for moving the individual safely to toilet or commode. Wipe perineum from front to back, towards the buttocks in one direction only.**



**Repeat if the wipe becomes heavily soiled, do not rub or scrub the skin, as this will damage compromised and fragile skin.**

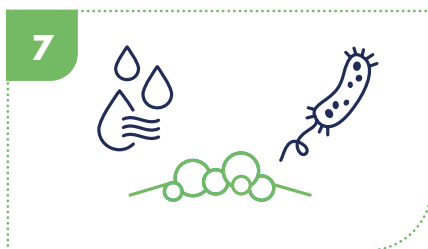

**The wipes will cleanse and moisturise the skin.**



**Dispose of wipes in the toilet, ensure no more than two wipes are disposed of at a time.**



**Allow skin to dry naturally and apply clean continence aids if required.**



Scan for more info



EBOS Code	Description
10007666	Conti Cleansing Wet Wipes, Pack of 12 x 50 - Pack of 50 Wipe Size: 22 x 17 cm), Fragrance Free
10021703	Conti Cleansing Wet Wipes, Pack of 27 x 24 - Pack of 24 (Wipe Size: 22 x 17 cm), Fragrance Free

## Vernacare

FOR MORE INFORMATION CONTACT YOUR ACCOUNT MANAGER  
ON **FREephone 1800 269 534** OR VISIT [www.eboshealthcare.com.au](http://www.eboshealthcare.com.au)

## EBOS HEALTHCARE

ESSENTIAL TO HEALTH